

Mover 205,300 Partner 255

etac®

art:1420021- Ambulating arm stopper

BM1201 2019-06-18 Rev A

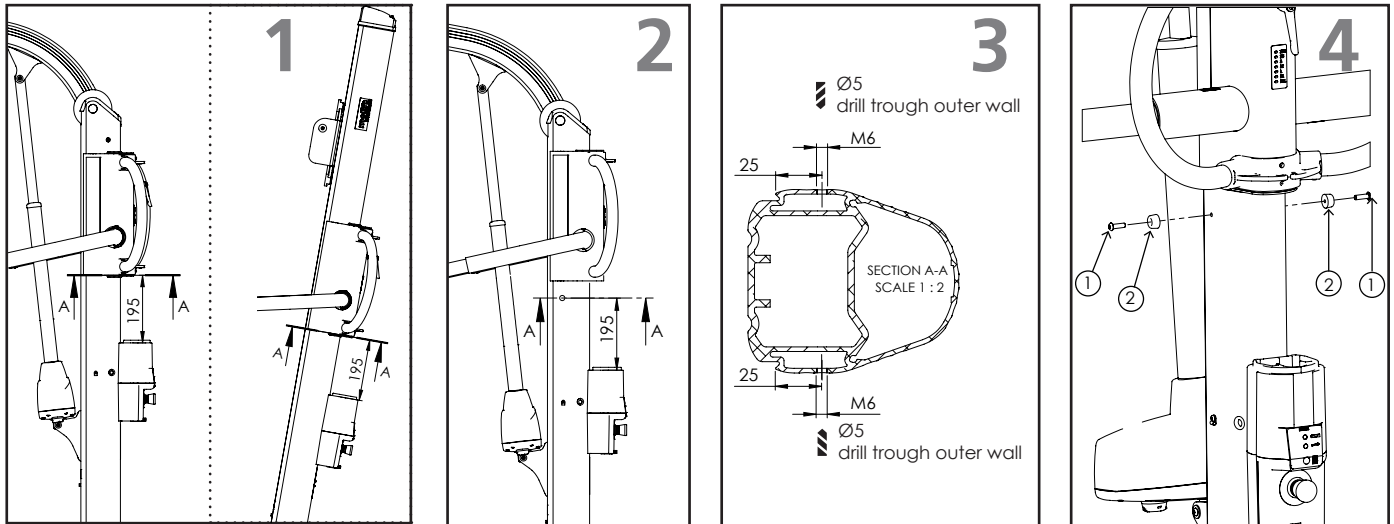

EN

How to mount stopper

- 1**
 - Remove battery
 - Adjust ambulating arm to 195 mm above top of battery case.
 - Set a mark on both side of column at A-A
- 2**
 - Set the ambulating arm to upper position
- 3**
 - Make a mark 25 mm from the column edge at the previous marked height. Do this on both sides of column
 - Drill a Ø5 hole through the outer wall of column. Do this on both sides of column
 - Make M6 threads in both holes.
- 4**
 - Insert bolt (1) into rubber stop (2). Screw bolt into column and tighten. Do this on both sides of column
 - Insert battery, then lower ambulating arms until it stops against the rubber stop. Make sure it is possible to remove the battery.